

SATIS OUTDOOR

INSTALLATION INSTRUCTIONS FOR LUMINAIRE SATIS OUTDOOR

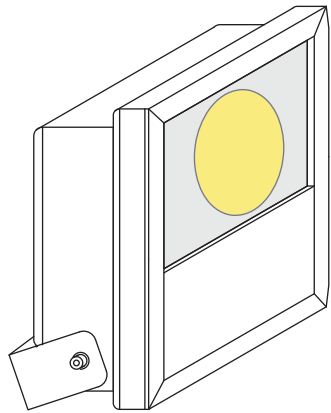

1 Installation
Fit the bracket on the wall with (2) screws

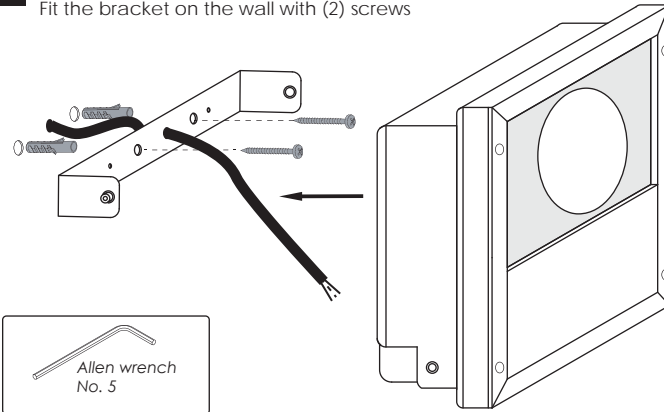

3 Screw fitting on wall bracket
Fit the silicon gasket and then the cover cap.

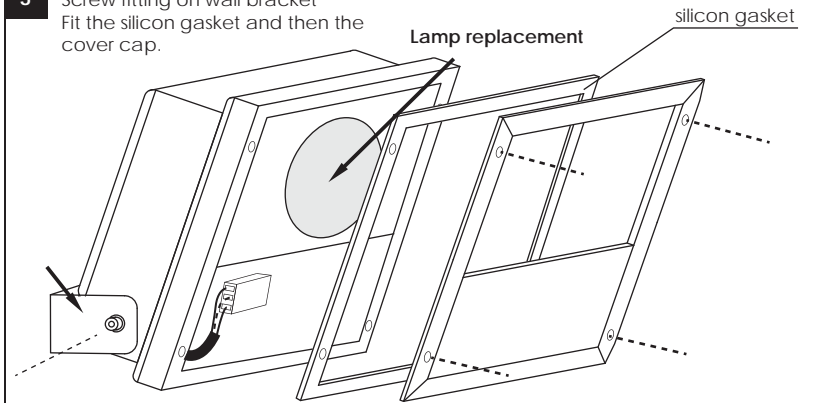

2 1. Release the (4) screws and remove the cap of the fitting
2. Insert cable through cable gland
3. Make wiring connection

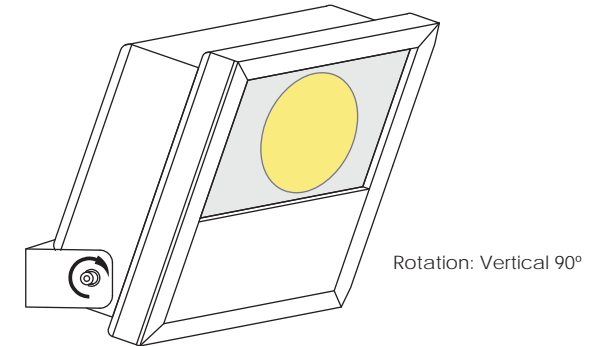
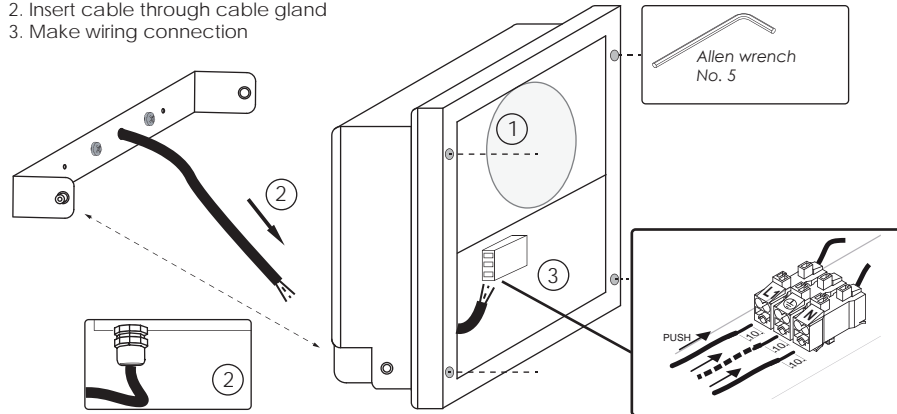

Technical features

Projected Area: 140°
Mounting height: 4m -12m (max)
Suitable for outdoor use
Dimensions (L X W X H)
140 x140 x 100 mm
Weight: 5 kg

USER INSTRUCTIONS

- The installation of the unit must be done by a qualified electrician.
- The unit must be earthed in case an earth connecting point exists.
- Ensure that the mains is switched off during servicing.
- Do not use bulb(s) bigger than the indicated on units name-plate or packaging.
- Ensure that after the installation, the unit is properly fixed and the cable clamps (if exist) are well tightened.
- Manufacturer will not accept liability for injury or damage resulting from incorrect use or installation
- The unit is not intended to operate in loop connection.
- Wall plugs and terminals are not included.

CAUTION
Replace any cracked shield

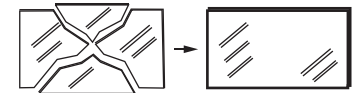

IP65  

Date Issued: July 2014