

# VIGOR IN XL

## installation instructions

→ indoor / downlights

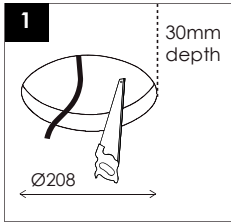

**1 Installation**  
Cut hole on the ceiling.  
Make wiring connections.

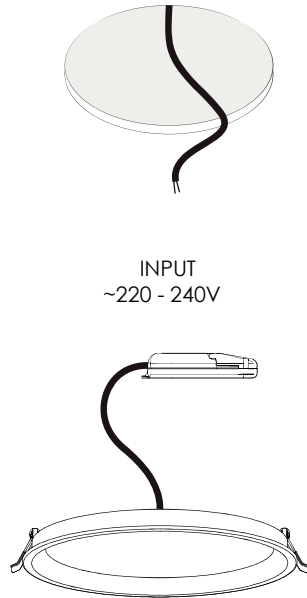
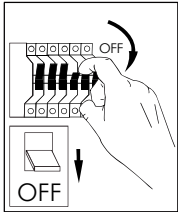

**2** Bend the spring upwards to fit the luminaire on ceiling.

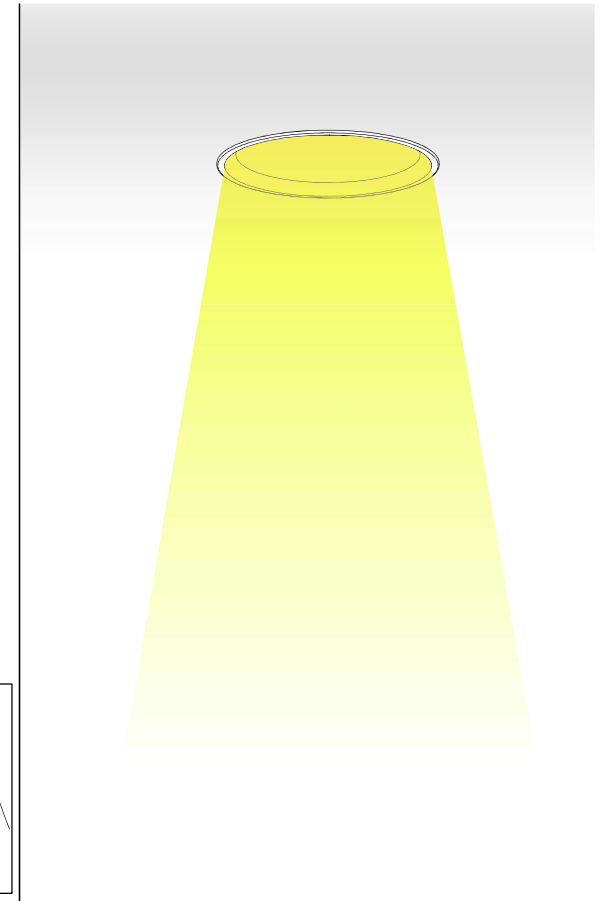
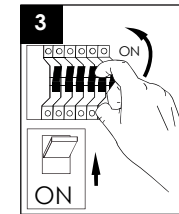
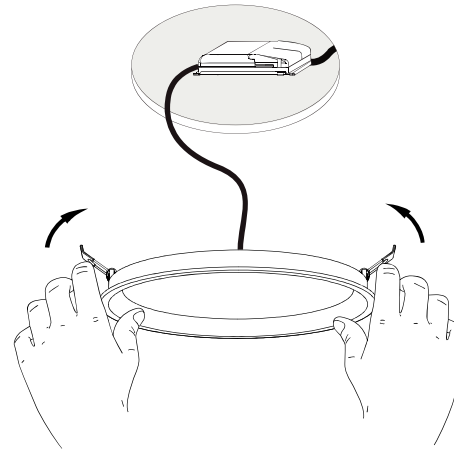

### USER INSTRUCTIONS

- The installation of the unit must be done by a qualified electrician.
- The unit must be earthed in case an earth connecting point exists.
- Ensure that the mains is switched off during servicing.
- Do not use bulb(s) bigger than the indicated on units name-plate or packaging.
- Ensure that after the installation, the unit is properly fixed and the cable clamps (if exist) are well tightened.
- Manufacturer will not accept liability for injury or damage resulting from incorrect use or installation
- The unit is not intended to operate in loop connection.
- Wall plugs and terminals are not included.
- LED modules are replaced only by the manufacturer.

### Factory

5 Kefalovrisou Str., Monomati, Acharnai, P.O. Box 13677, Athens, Greece  
Tel: (+30) 210 6208 230 | E-mail: info@bright.gr | www.bright.gr